

Start Up Procedures

Sundance 980 Series

- 1) Fill the spa to the pillows
- 2) Turn the breaker on and **walk away for 4-6 hours**
Let the spa do it's thing.
Pumps will come on and off and the indicator light will be **RED**
Screen will show error codes – Don't worry, this is what it's supposed to do.
- 3) **After 4-6 hours** you can program the spa. These are the important settings.
 - a. Set **HEAT & FILTER** to **AUTO** (Factory default is AUTO)
 - b. Set **PRIMARY FILTER** to **24 Hours** (Factory default is 8 hours)
(There are other settings like Time, Date, Language and Units too)
- 4) Turn the jets on and slowly add the entire bottle of **Ph Balance Plus**
YES – The whole bottle. Locks in pH & TA so you don't test or adjust
- 5) Insert the @EASE FROG Sanitizers - Set the **Blue** dial to **3** and **Sliver** dial to **7** and place them in the holder above the filter. (You can set it higher for heavy use)



Unlock and go to Settings

Swipe across to unlock controls

Press the  icon

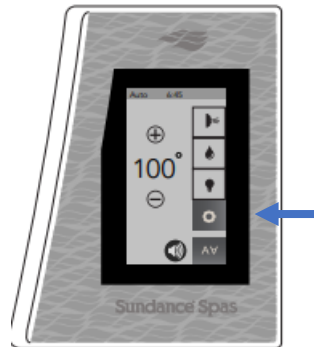

SET HEAT TO AUTO

PRESS Arrow UP or DOWN

PRESS Auto

PRESS Heat & Filter

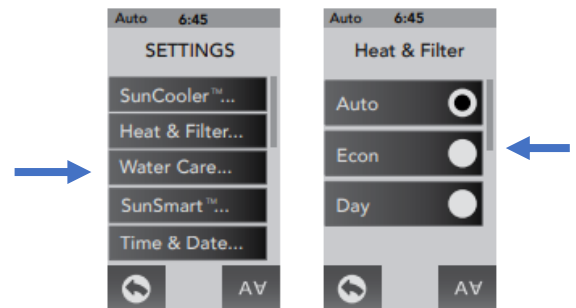

SET PRIMARY FILTRATION TO 24 HRS

Press **Heat & Filter** in **Settings**

Press **Primary**

Set "Start" and "End" times to same time.

12.3 Programming the Primary Filtration

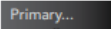
To access the "Primary" feature, tap  from the Heat and Filter menu, Figure 12.3a, to enter the "Primary" programming, Figure 12.3b. If the Primary tab does not appear on the LCD display, swipe the screen upward to view additional options.

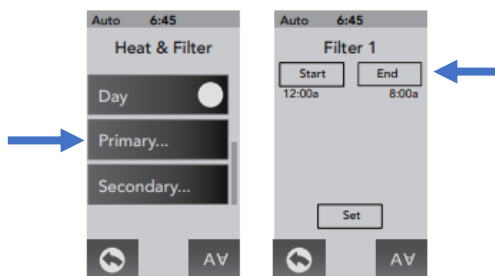

Figure 12.3a

Figure 12.3b

SET SECONDARY FILTRATION

Press **Heat & Filter** in **Settings**

Press **Secondary**

Press **Frequent**

12.4 Programming the Secondary Filtration

To access the "Secondary" feature, tap  from the Heat and Filter Menu, Figure 12.4a, to enter the "Secondary" programming, Figure 12.4b.



Figure 12.4a

Figure 12.4b

Maintenance Timing

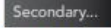
Twice a month	½ cap of Enhanced Shock (You can use it immediately – No need to wait to get in)
Monthly	Replace Silver Cartridge
4 months	Replace Blue Cartridge
4-6 months	Replace inner core filter (We gave you a new one)
6 months	Drain and Clean
Yearly	Replace Clear Ray bulb (It's easy. Replacement bulbs are always in stock)
2 years	Replace the outer pleated filter

Your spa has programable timers as reminders for the following:

- Replace inner filter
- Replace outer filter
- Change water
- Replace Clear Ray Bulb

These are just timers that you control. You can set them to remind you or you can turn them off.

Remember they are like an alarm clock. They don't know that you changed the water. Reset them after they alert you.

First questions you will have

(There's no questions you shouldn't ask)

How do you access equipment area?

Grab corners at bottom and pull then they will drop down

Pull the top of the center cabinet towards you, until it unclips all the way across. Then lift straight up

Remove the light from inside the front panel and set the panel aside

Figure A

Remove Corners
(unclip bottom
first)

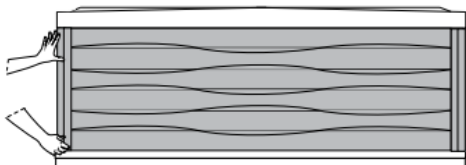

Unclip across
the top

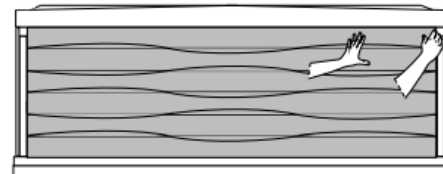

Some of the jets don't work

- 1) Make sure both pumps are on and that the **diverter valve** is in the middle position (It's the big one)
- 2) Turn the outside ring of the jet to adjust the flow. You can adjust the flow on almost all the jets except the therapy seat. Some of the jets could be in the off position.

Water Quality

Cloudy

- First –** Have you replaced your Clear Ray bulb within the last year?
Have you replaced your Silver cartridge within the last month?
Have you replaced the Blue cartridge within the last 4 months?

If So: Increase filter times if not already set to 24 hours
Add ½ Cap of Enhanced Shock daily until clear (Probably 2 days)

Foam

Foam is mainly caused by laundry detergent in swim suits. We sell **defoamer** that you can squirt into the tub. It creates a scum line you can wipe off and you may need to repeat it's use.

How do I replace the Clear Ray Bulb?

- 1) Shut off the breaker!!
- 2) Locate the Clear Ray System in the equipment area. Close to the center control box.
- 3) Remove the 4 screws and take off the front cover.
- 4) Unplug the bulb and pull it straight out. DON'T TILT IT.
- 5) Insert the new bulb and connect the plug.
- 6) Attach the cover with the 4 screws
- 7) RESET the Clear Ray timer to "365"

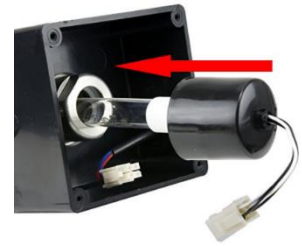

Most Common Error

FLOW ERROR Heater is disabled. 99% of the time this is a clogged filter. Usually the inner core.

Turn off the spa. Remove the filter. Turn the spa on and wait 5 minutes. If the FLOW ERROR went away then replace your inner core filter and hose off the outer pleated filter.

Drain & Clean (Every 6 months) *Here's what I do but you can do it however you like*

Hook garden hose to the drain hose in the corner of spa

OR

RV dump style drain in the equipment area

Remove the cap and attach the drain hose (Its zip tied to the drain)

Turn to unlock and **Pull** to start the flow. Or use a submersible pump.

While it's draining clean the top of the shell down to below the water level.

(I like Lysol or Chlorox spray cleaner and a Dobie Sponge)

Remove the pillows if you want to get it clean behind them.

While it's draining, use a high-pressure hose nozzle and rinse down the shell.

Blast around all of the jets in case there's something growing back there.

Use the high pressure to get the dirty water out of the seats and keep spraying while the tub drains until you have clean water in the seats and footwell.

Don't worry about the sand and small debris, we'll get that later. Or you can use a shop vac and suck it out.

Hose off the filter really well.

Clean the underside of the cover and hose it off. Clorox cleaner or Lysol work great to keep it fresh.

Do **Start Up Procedure** 1,2,4 & 5 and you're ready to go (Top of pg 1)

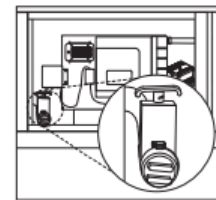

Now let's get the sand out. When the spa is full leave the hose submerged in the spa. Turn off the water and disconnect the hose at the hose bib and set on the ground. The water will siphon out of the tub. Use the hose end in the tub to suction out the debris. Or you can buy a handy Quick Vac wand from us.

A note about chemicals and supplies

We stock only the highest quality and efficient products in order to reduce the use of chemicals and maintenance time for you.

Having purchased your spa from North Idaho Spas entitles you to 10% off all chemical purchases.

With that discount we beat internet prices on almost every item we sell.